

Operation and Maintenance Instructions for Vinyl Single-Hung Replacement Windows

The Silver Line® vinyl single-hung replacement window you have purchased has been designed and manufactured to be thermally efficient, virtually maintenance-free and easy to operate. With a minimum amount of care and maintenance, these windows should last for as long as you own your home.

Cleaning Instructions

Periodic cleaning of your vinyl replacement windows is recommended to ensure proper operation. Dirt can limit the natural lubricating ability of vinyl and cause difficulty in operation. The vinyl surfaces of your replacement windows can be cleaned with a mild soap and water solution. Do not use harsh detergents as they are detrimental to the vinyl's finish. Occasional cleaning will ensure many years of beauty and easy operation.

Operation Instructions

To raise the lower sash, first unlock the window. Then, raise the bottom sash by grasping the lift rail, located at the bottom of the lower sash, with both hands and lifting upward.

Tilt-In Sash

To tilt the sash into the home for safe, easy cleaning, unlock and raise the bottom sash approximately 3" from the sill. Using your index fingers, slide the tilt latches toward the center of the window (see Figure 1). With the tilt latches still fully depressed, pull the sash inward until the tilt latches clear the window frame (see Figure 2). Rotate the sash downward slowly so the sash can rest on the window sill (see Figure 3). To return the window sash to its original position, rotate upward until the tilt latches engage behind the sides of the window frame.

Note: When the sash is tilted inward for cleaning, the balance shoe should lock into place. If the shoe does not lock completely and retracts upon moving the sash, simply place the tip of a flat head screwdriver into the pivot bar hole, pull the shoe to the desired location and twist the screwdriver inward until the balance shoe locks into place.

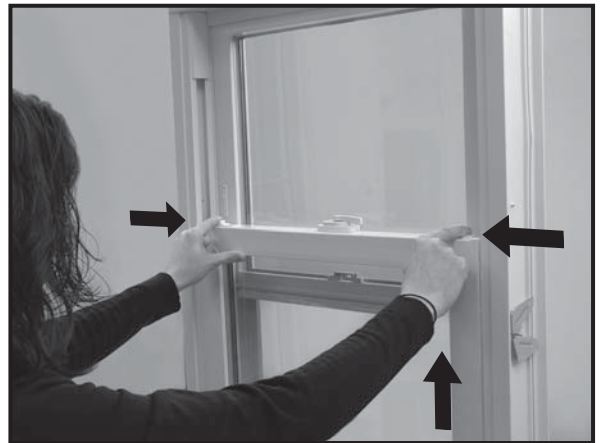

(Figure 1)



(Figure 2)



(Figure 3)